

### AC acceleration and PT100 temperature output via M12 Connector

- PT100 temperature output
- Side entry for easy access
- Premium design

Building services, Pulp and Paper,  
Mining, Metals, Utilities, Automotive,  
Water, Pharmaceutical

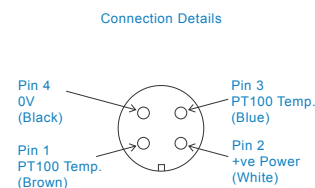
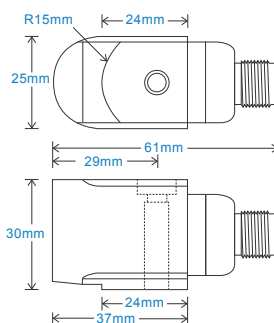

Technical Performance		Mechanical	
Mounted Base Resonance	see 'How To Order' table (nominal)	Case Material	Stainless Steel
Sensitivity	see: 'How To Order' table $\pm 10\%$	Sensing Element/Construction	PZT/Shear
	Nominal 80Hz at 22°C	Mounting Torque	8Nm
Frequency Response	1.5Hz (90cpm) to 10kHz (600kcpm) $\pm 5\%$	Mounting Bolt Provided	see: 'How To Order' table x 35mm long
	0.5Hz (30cpm) to 12kHz (720kcpm) $\pm 10\%$	Weight	205gms (nominal)
	0.2Hz (12cpm) to 15kHz (900kcpm) $\pm 3\text{dB}$	Screened Cable Assembly	HS-AC010 - straight
Isolation	Base isolated		HS-AC011 - right angle
Range	see: 'How To Order' table	Mounting Threads	see: 'How To Order' table
Temperature Output	PT100 (100 Ohms)		
Transverse Sensitivity	Less than 5%		

Electrical		Environmental	
Electrical Noise	0.1mg max	Operating Temperature Range	-55 to 130°C
Current Range	0.5mA to 8mA	Sealing	IP67
Bias Voltage	10 - 12 Volts DC	Maximum Shock	5000g
Settling Time	1 second	EMC	EN61326-1:2013
Output Impedance	200 Ohms max.		
Case Isolation	>10 <sup>8</sup> Ohms at 500 Volts		

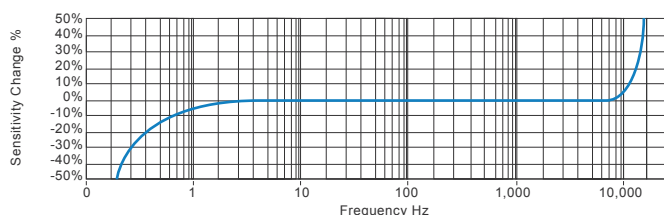

Fans, Motors, Pumps, Compressors,  
Centrifuges, Conveyors, Air Handlers,  
Gearboxes, Rolls, Dryers, Presses,  
Cooling, VAC, Spindles, Machine Tooling,  
Process Equipment

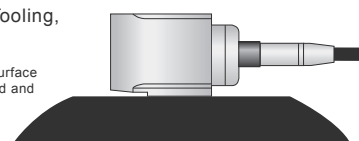

Vibration sensor should be firmly fixed to a flat surface (spot face surface may be needed to be produced and cable anchored to sensor body.)

Product Prefix		Product Series					Cable Length (if integral cable)								
HS - Hansford Sensors		150 - Premium Industrial Vibration Sensor					QXX - length specified in metres								
H	S	1	5	0	S	R	T	X	X	X	X	X	X	X	X
Extra Options (if required)		Sensitivity		Range		Resonant Frequency		Cable/Connector		Mounting Threads					
F - Filtered		010 - 10mV/g		±800g		27kHz (1,620kcpm)		01 - PUR		02 - ¼-28" UNF Male					
L - 316L Stainless Steel		030 - 30mV/g		±250g		25kHz (1,500kcpm)		03 - Braided		06 - M6 x 1mm Male					
RT - Temperature Output PT100		050 - 50mV/g		±160g		23kHz (1,380kcpm)		07 - Silicon		08 - M8 x 1.25mm Male					
S - 90° Side Exit		100 - 100mV/g		±80g		21kHz (1,260kcpm)		15 - Flame Retardant							
Y - 5% tolerance on sensitivity		250 - 250mV/g		±32g		19kHz (1,140kcpm)		52 - 3 Pin MS							
		500 - 500mV/g		±16g		17kHz (1,020kcpm)		54 - M12							